

# Eclipse II (Steel) 10 x 15 Frame Replacement Parts

**NOTES:**

1. ALL HARDWARE IS SHOWN BOLT TO NUT FROM OUTSIDE IN.
2. ARROWS SHOW INTERNAL ORIENTATION OF INNER TRUSS ASSY'S FROM BOLT TO NUT.
3. ALL HARDWARE IS VIEWED FROM TOP VIEW.

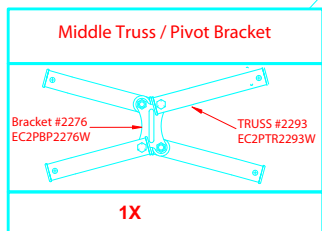
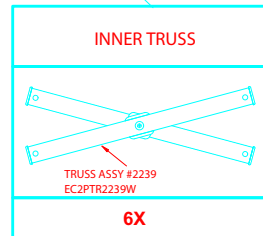
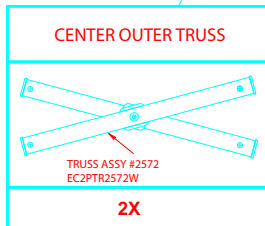
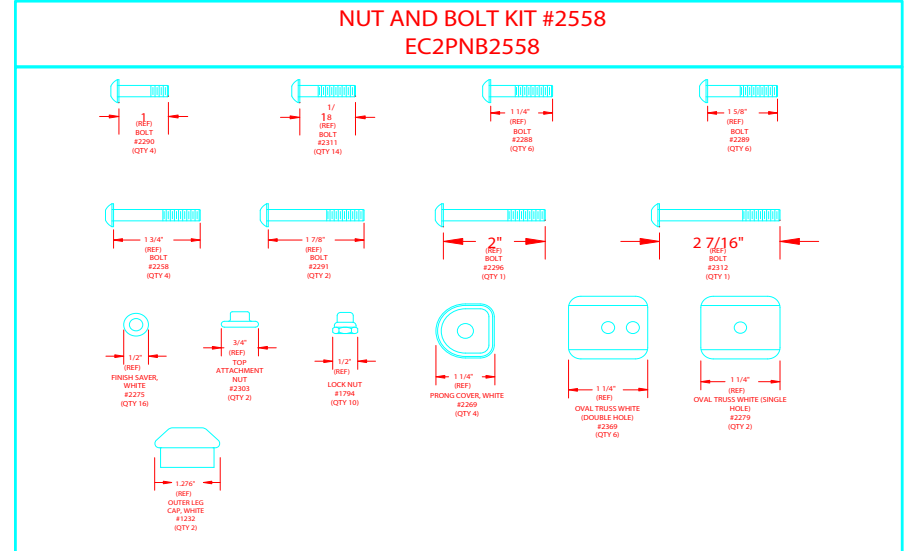
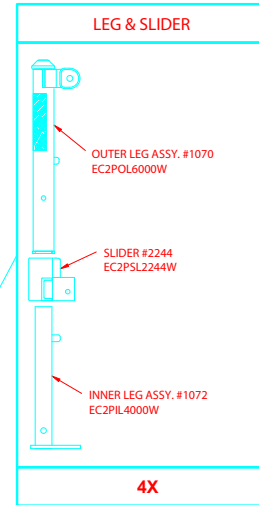
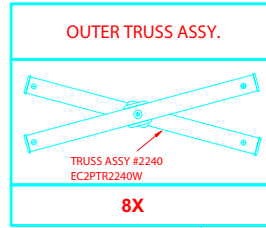
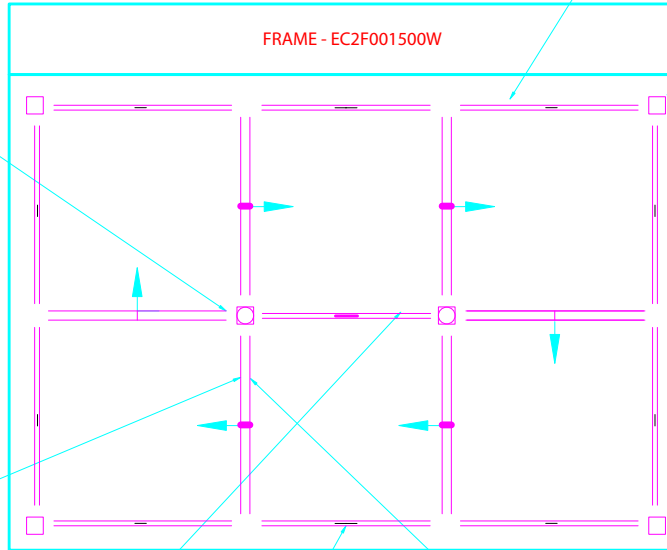
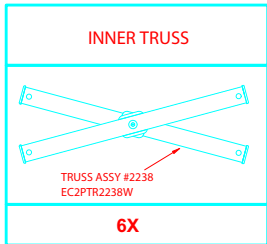
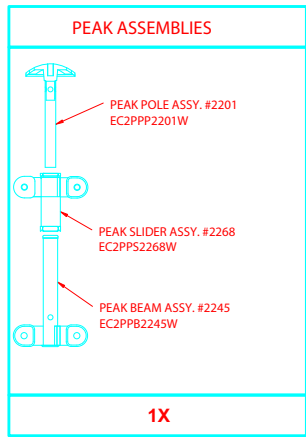

## Eclipse II (Steel) 10 X 15 Frame Replacement Parts

<u>Item</u>	<u>Desc.</u>	<u>Retail</u>
EC2F001500W	FRAME, ECLIPSE II 15', WHITE	390.00
EC2PBP2276W	BRACKET,PIVOT,10 x 15, WHITE	6.00
EC2PIL4000W	INNER LEG, ECLIPSE II, 40"	17.00
EC2PNB2558	NUT & BOLT KIT, ECLIPSE II	6.50
EC2POL6000W	OUTER LEG, ECLIPSE II, 10'	37.50
EC2PPB2245W	PEAK BEAM ASSY, ECLIPSE II 30"	17.00
EC2PPP2201W	PEAK POLE , ECLIPSE II 36 1/8	18.50
EC2PPS2268W	PEAK SLIDER ECLIPSE II , 8'	9.50
EC2PSL2244W	SLIDER, OUTER LEG , ECLIPSE II	7.00
EC2PTR2238W	INNER TRUSS ECLIPSE II 56.625"	9.75
EC2PTR2239W	INNER TRUSS, ECLIPSE II 58.625	9.75
EC2PTR2240W	OUTER TRUSS, ECLIPSE II, 59.00	9.75
EC2PTR2293W	TRUSS MIDDLE PEAK, 27 3/8	6.50
EC2PTR2572W	CENTER OUTER TRUSS ECLIPSE II	9.75