



www.gillathletics.com
800-637-3090

F910 - VersaCom Box - Synthetic Version

SPECIFICATIONS

The VersaCom Box provides a junction for electricity and cable hookups. This box can be put in virtually any location around performance areas of varying surfaces. The open bottom of the VersaCom Box provides adequate drainage and conduit entry, while the hand holes in the cover allow easy access. A divider plate is also provided to help keep electrical equipment segregated. The main box structure is made of $\frac{1}{4}$ " thick folded aluminum. The lid is constructed out of $\frac{1}{8}$ " aluminum, reinforced by angle and 1" square tubing for maximum durability. Welded lid support angles are compatible with all style lids. Synthetic track surface is installed in the lid by the contractor to match the surrounding surface.

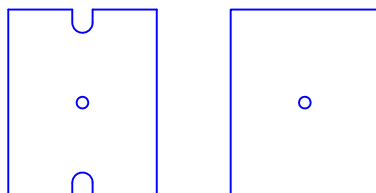
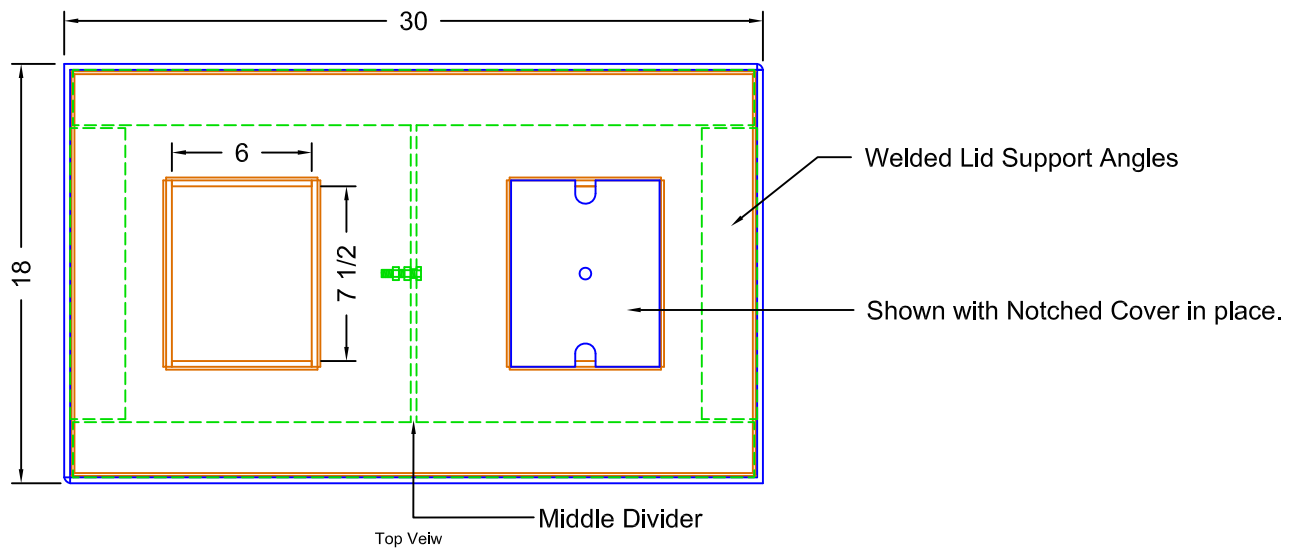
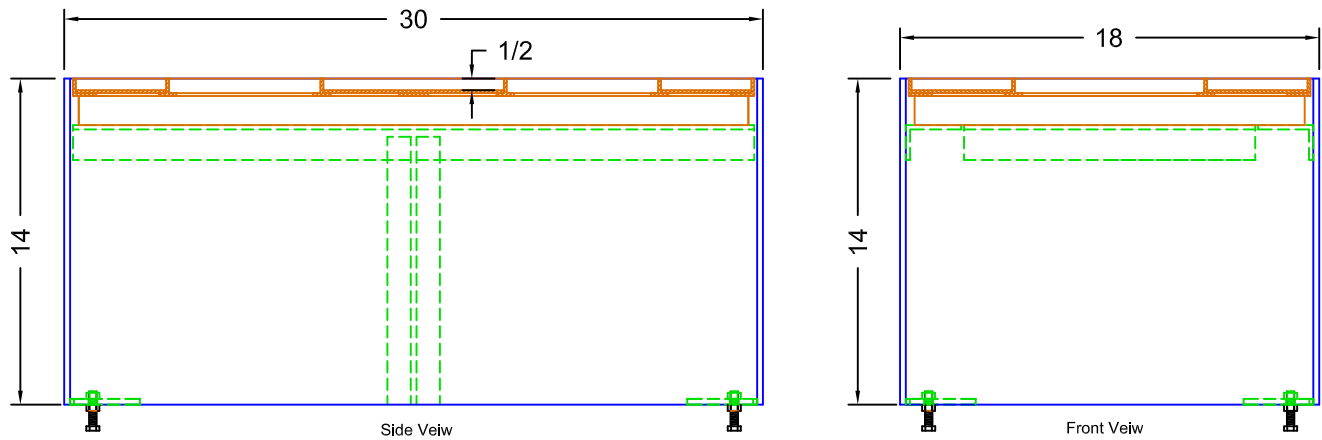

Each lid comes with two sets of captive covers. Each set consists of one notched cover for use with cables entering the box and one solid cover for use when the box is not in use.